

SIZE	A	ØB	C	D	G	H	G	H	W	C1	C2
1/2"	2.64	0.36	1.73	4.37	0.50	1.12	0.50	1.12	10-24UNC	0.53	1.10
3/4"	2.80	0.49	1.89	4.37	0.50	1.12	0.50	1.12	10-24UNC	0.65	1.34
1"	3.35	0.63	2.36	5.55	0.87	1.37	0.87	1.37	10-24UNC	0.81	1.59
1 1/4"	3.70	0.79	2.56	5.55	0.87	1.37	0.87	1.37	10-24UNC	0.98	1.77
1 1/2"	3.94	0.98	2.80	6.34	0.93	1.50	0.93	1.50	1/4"-20UNC	1.12	2.11
2"	4.65	1.26	3.03	6.34	0.93	1.50	0.93	1.50	1/4"-20UNC	1.36	2.32

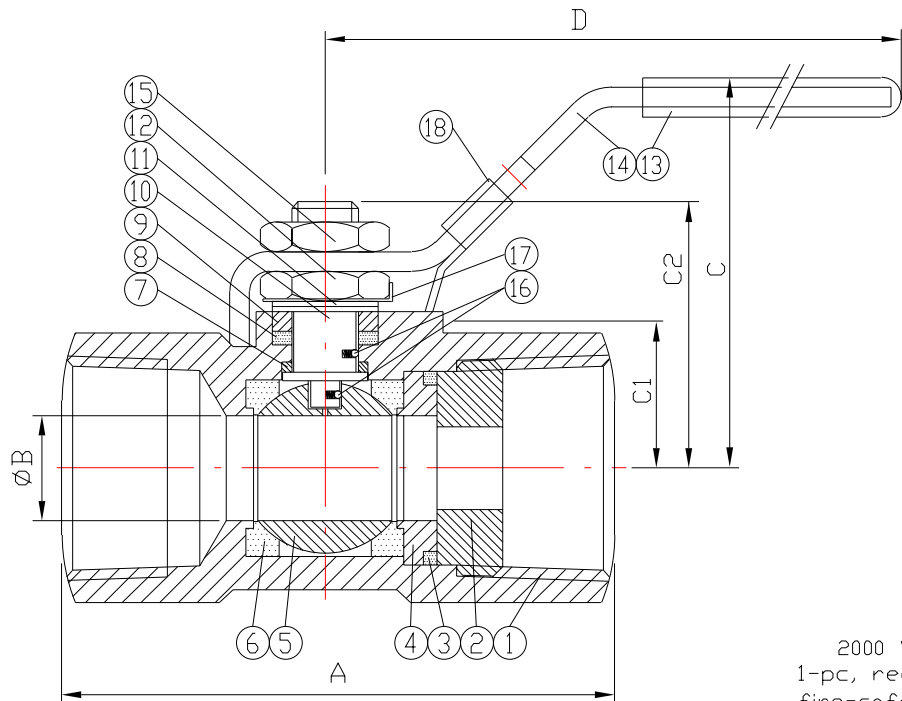

2000 WDG  
1-pc, reduced port,  
fire-safe design

ITEM	DESCRIPTION	S20-316	Qty
1	BODY	ASTM A351-CF8M	1
2	RETAINER NUT	ASTM A351-CF8M	1
3	GASKET	Graphite	1
4	SEAT RETAINER	ASTM A351-CF8M	1
5	BALL	ASTM A351-CF8M	1
6	SEAT	Carbon filled TFE	2
7	THRUST WASHER	R.TFE	1
8	STEM PACKING	Graphite	1
9	GLAND	SS 304	1
10	STEM	ASTM A479 Gr 316	1
11	BELLEVILLE WASHER	SS 301	2
12	PACKING NUT	SS 304	1
13	HANDLE COVER	PVC	1
14	HANDLE	SS 304	1
15	HANDLE NUT	SS 304	1
16	ANTISTATIC DEVICE	SS 316	1
17	TAB WASHER	SS 304	1
18	LOCKING DEVICE	SS 304	1

FLOW-TEK, INC.

11850 Tanner Road  
Houston, Texas 77041

TEL: 832-912-2300  
FAX: 832-912-2301

SERIES #  
S20

SIZE :  
1/2"-2"

DRAWING TITLE : S20 Ball Valve Assembly Drawing (Fire Safe)

SCALE : N.T.S.

DRAWN BY : xx

REV. LEVEL

DATE : Feb. 13, 2004

APPROVED BY : WSB

00

CUSTOMER :

DRAWING NO. :

S20FS-SD